

CH210A - 02 DRUM

20,000 LB First Layer Line Pull

BRADEN®

DIMENSIONAL INFORMATION

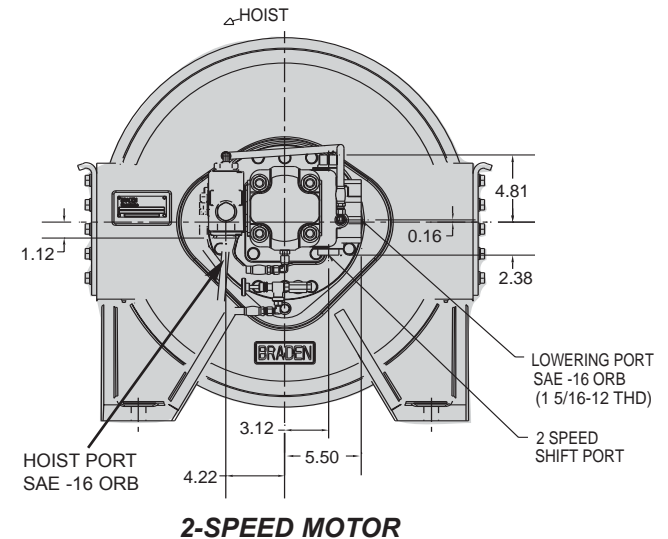
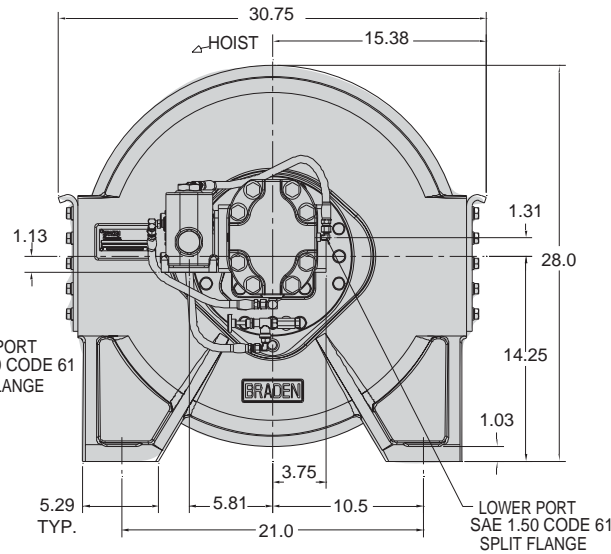
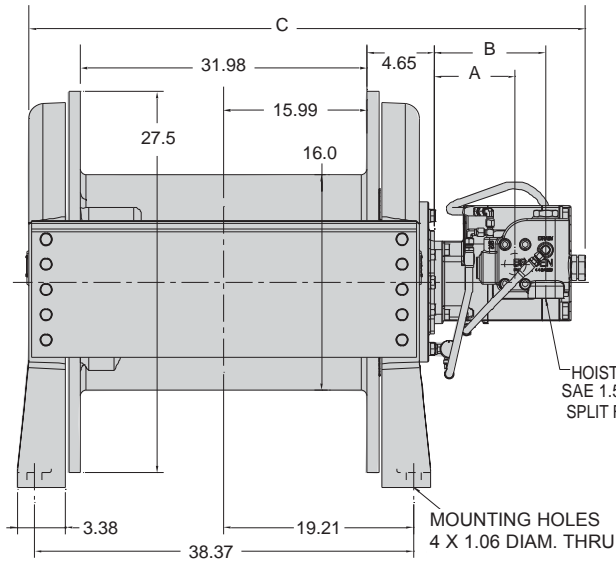

MOTOR	A	B	C
090	5.38	7.50	50.44
110	5.63	7.75	50.69
120	5.75	7.88	50.82
128/064	8.56	10.56	55.69

- Increased line pull ratings to better utilize higher strength wire ropes
- Gearing is designed for improved service life at higher input RPM and higher input torque
- New brake design increases allowable input RPM, overrunning clutch capacity and oil flow to the brake
- SAE "C" and "D" motor mounts for improved hydraulic motor compatibility
- Optional electronic rotation sensor
- Same mounting hole locations and envelope size as the CH185A
- Improved serviceability

MOTOR OPTIONS

090	9.02 cu in.
110	11.03 cu in.
120	12.03 cu in.
128/064	12.76/6.38 cu in. (2 speed)

Consult the factory for additional drum and hydraulic motor options.

PACCAR WINCH DIVISION
 P.O. Box 547 Broken Arrow, Oklahoma 74013
 PHONE: (918) 251-8511 FAX: (918) 259-1575
www.paccarwinch.com

PERFORMANCE INFORMATION

ROPE SIZE	LAYER	090 MOTOR				110 MOTOR				120 MOTOR				ROPE CAPACITY	
		LINE PULL		LINE SPEED		LINE PULL		LINE SPEED		LINE PULL		LINE SPEED			
		(LBS)	(KG)	(FPM)	(MPM)	(LBS)	(KG)	(FPM)	(MPM)	(LBS)	(KG)	(FPM)	(MPM)		
		9.02 CU. IN. DISP. - 3000 ΔPSI @ 125 GPM** (148 CC DISP. - 207 Δbar @ 473 LPM*)				11.03 CU. IN. DISP. - 3000 ΔPSI @ 155 GPM** (181 CC DISP. - 207 Δbar @ 587 LPM*)				12.04 CU. IN. DISP. - 3000 ΔPSI @ 170 GPM** (197 CC DISP. - 207 Δbar @ 643 LPM*)					
3/4	1	13,890	6,301	366	112	17,470	7,924	371	113	19,270	8,741	373	114	186	56.7
	2	12,750	5,783	399	122	16,040	7,276	404	123	17,680	8,020	407	124	389	119
	3	11,780	5,343	432	132	14,820	6,722	438	134	16,340	7,412	440	134	609	186
	4	10,950	4,967	465	142	13,770	6,246	471	144	15,190	6,890	474	144	846	258
	5	10,230	4,640	497	151	12,870	5,838	504	154	14,180	6,432	507	155	1,099	335
	6	9,600	4,355	530	162	12,070	5,475	538	164	13,310	6,037	541	165	1,369	417
	7*	9,040	4,101	563	172	11,370	5,157	571	174	12,530	5,684	574	175	1,656	505
7/8	1	13,790	6,255	369	112	17,340	7,865	374	114	19,120	8,673	376	115	161	49.1
	2	12,500	5,670	407	124	15,710	7,126	413	126	17,330	7,861	415	126	339	103
	3	11,420	5,180	445	136	14,370	6,518	452	138	15,840	7,185	454	138	533	162
	4	10,520	4,772	484	148	13,230	6,001	490	149	14,580	6,613	493	150	744	227
	5	9,750	4,423	522	159	12,260	5,561	529	161	13,520	6,133	532	162	972	296
	6*	9,080	4,119	560	171	11,420	5,180	568	173	12,590	5,711	571	174	1,217	371

* This layer does not comply with ANSI standard B30.5 for 1/2 inch exposed flange.

** Consult factory for flows above 120 GPM (454 LPM)

NOTES

Specifications are subject to change without notification and without incurring obligation.

Pressure and flow shown are the maximum allowable for the particular combination of winch, ratio, motor and drum.

Specifications in this publication are theoretical and may vary depending on hydraulic system, environment, etc.

Line pulls are maximum ratings for the winch only. Wire rope ratings may be lower than the winch rating. Consult the wire rope manufacturer for ratings

ROPE SIZE	LAYER	TWO SPEED MOTOR							
		LOW SPEED				HIGH SPEED			
		LINE PULL		LINE SPEED		LINE PULL		LINE SPEED	
		12.74 CU. IN. DISP. - 2920 ΔPSI @ 85 GPM (209 CC DISP. - 201 Δbar @ 322 LPM)				6.38 CU. IN. DISP. - 2920 ΔPSI @ 85 GPM (105 CC DISP. - 201 Δbar @ 322 LPM)			
(in.)		(LBS)	(KG)	(FPM)	(MPM)	(LBS)	(KG)	(FPM)	(MPM)
3/4	1	20,120	9,126	168	51	9,110	4,132	345	105
	2	18,470	8,378	183	56	8,360	3,792	376	115
	3	17,060	7,738	199	61	7,730	3,506	406	124
	4	15,860	7,194	214	65	7,180	3,257	437	133
	5	14,810	6,718	229	70	6,710	3,044	468	143
	6	13,900	6,305	244	74	6,290	2,853	499	152
	7*	13,090	5,938	259	79	5,930	2,690	530	162
7/8	1	19,970	9,058	170	52	9,050	4,105	347	106
	2	18,090	8,206	187	57	8,200	3,720	383	117
	3	16,540	7,503	205	62	7,490	3,397	419	128
	4	15,230	6,908	223	68	6,900	3,130	455	139
	5	14,120	6,405	240	73	6,390	2,899	491	150
	6*	13,150	5,965	258	79	5,960	2,703	528	161

* This layer does not comply with ANSI standard B30.5 for 1/2 inch exposed flange.

MINIMUM FLOW RECOMMENDATION FOR SMOOTH OPERATION

(RECOMMENDED MINIMUM SYSTEM FLOW SHOULD BE 2X THESE VALUES)

MOTOR	GPM	LPM
090	24	91
110	27	102
120	28	106
128/064	CONSULT FACTORY	

OPTIONS

Consult the factory for high pressure piston motors and available ratios.

WARNING

A minimum of 5 wraps of wire rope must be left on the drum to prevent the load from being supported by the wire rope anchor alone. Since the wire rope anchor is not designed to hold the rated load, failure to leave 5 wraps of wire rope on the drum could cause the load to drop, which could result in property damage, injury or death.

COMMITMENT

Every process in the design, manufacture and support of BRADEN products is focused on one goal: Providing the highest quality winch, hoist and drive systems in the world. PACCAR Winch Division is committed to providing the best in product functionality and reliability.

Since 1905 PACCAR Inc has provided high quality products and services to numerous markets and countries. Let us put our experience and expertise to work for you.