

CH230B - 01 DRUM

23,000 LB First Layer Line Pull

BRADEN®

DIMENSIONAL INFORMATION

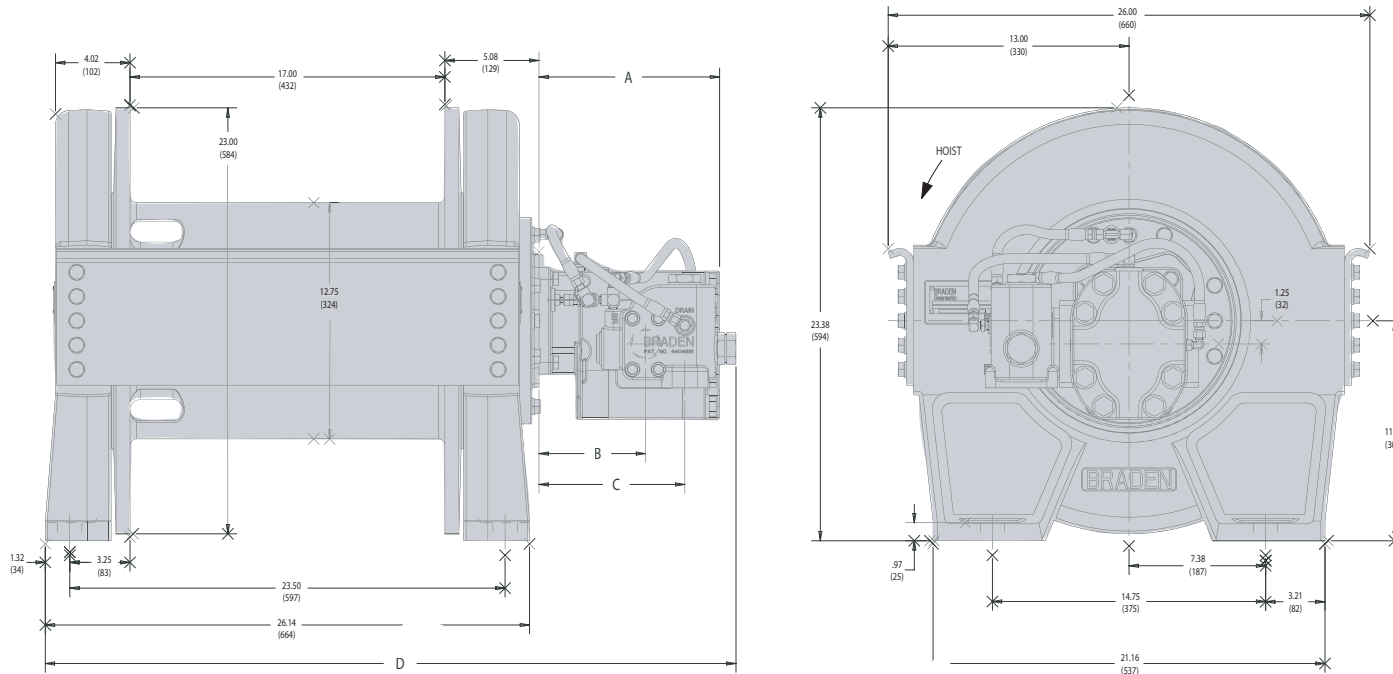

HOIST FEATURES

- Increased line pull ratings to better utilize higher strength wire ropes
- Gearing is designed for improved service life at higher input RPM and torque
- New brake design increases allowable input RPM, overrunning clutch capacity & oil flow to the brake
- SAE “C” and “D” motor mounts for improved hydraulic motor capability
- Optional electronic rotation sensor
- Same mounting hole locations and envelope size as the CH230A
- Improved serviceability

| | CH230B | | | | | | | |
|---|-----------|-----|-----------|-----|-----------|-----|---------------|-------|
| | 090 Motor | | 110 Motor | | 120 Motor | | 128/064 Motor | |
| | in. | mm | in. | mm | in. | mm | in. | mm |
| A | 10.25 | 260 | 9.50 | 241 | 9.75 | 248 | 15.00 | 381 |
| B | 5.38 | 137 | 5.63 | 143 | 5.75 | 146 | 6.47 | 164 |
| C | 7.50 | 191 | 7.75 | 197 | 7.88 | 200 | 8.13 | 207 |
| D | 36.91 | 938 | 37.16 | 944 | 37.29 | 947 | 41.65 | 1,060 |

PERFORMANCE INFORMATION

| | | 110 MOTOR - 01 DRUM | | | | 120 MOTOR - 01 DRUM | | | | 090 MOTOR - 02 DRUM | | | | 01 DRUM | |
|-------------------|-------|--|-------|------------|-------|--|--------|------------|-------|---|-------|------------|-------|---------------|-----|
| | | 11.03 CU. IN. DISP. - 3000 PSI @ 155 GPM (181 CC DISP. - 206 BAR @ 587 LPM) | | | | 12.03 CU. IN. DISP. - 2970 PSI @ 170 GPM (197 CC DISP. - 204 BAR @ 643 LPM) | | | | 9.02 CU. IN. DISP. - 3000 PSI @ 125 GPM (148 CC DISP. - 206 BAR @ 473 LPM) | | | | | |
| ROPE SIZE (IN) | LAYER | LINE PULL | | LINE SPEED | | LINE PULL | | LINE SPEED | | LINE PULL | | LINE SPEED | | ROPE CAPACITY | |
| | | (LBS) | (KG) | (FPM) | (MPM) | (LBS) | (KG) | (FPM) | (MPM) | (LBS) | (KG) | (FPM) | (MPM) | (FT) | (M) |
| 3/4 | 1 | 21,080 | 9,582 | 306 | 93 | 23,000 | 10,455 | 310 | 94 | 16,760 | 7,618 | 297 | 91 | 80 | 24 |
| | 2 | 18,970 | 8,623 | 340 | 104 | 20,700 | 9,409 | 344 | 105 | 15,080 | 6,855 | 330 | 101 | 169 | 52 |
| | 3 | 17,250 | 7,841 | 374 | 114 | 18,820 | 8,555 | 379 | 116 | 13,710 | 6,232 | 363 | 111 | 266 | 81 |
| | 4 | 15,810 | 7,186 | 408 | 124 | 17,250 | 7,841 | 413 | 126 | 12,570 | 5,714 | 396 | 121 | 372 | 113 |
| | 5 | 14,590 | 6,632 | 442 | 135 | 15,920 | 7,236 | 448 | 137 | 11,600 | 5,273 | 429 | 131 | 487 | 148 |
| | 6 | 13,550 | 6,159 | 477 | 145 | 14,780 | 6,718 | 482 | 147 | 10,770 | 4,895 | 462 | 141 | 611 | 186 |

| | | TWO SPEED MOTOR | | | | | | | |
|-------------------|-------|---|--------|------------|-------|--|-------|------------|-------|
| | | LOW SPEED | | | | HIGH SPEED | | | |
| | | 12.75 CU. IN. DISP. - 2765 PSI 85 GPM (209 CC DISP. - 190 BAR @ 322 LPM) | | | | 6.38 CU. IN. DISP. - 2765 PSI @ 85 GPM (104 CC DISP. - 190 BAR @ 322 LPM) | | | |
| ROPE SIZE (IN) | LAYER | LINE PULL | | LINE SPEED | | LINE PULL | | LINE SPEED | |
| | | (LBS) | (KG) | (FPM) | (MPM) | (LBS) | (KG) | (FPM) | (MPM) |
| 3/4 | 1 | 23,000 | 10,455 | 129 | 39 | 8,860 | 4,027 | 279 | 85 |
| | 2 | 20,700 | 9,409 | 144 | 44 | 7,980 | 3,627 | 310 | 94 |
| | 3 | 18,820 | 8,555 | 158 | 48 | 7,250 | 3,295 | 341 | 104 |
| | 4 | 17,250 | 7,841 | 173 | 53 | 6,650 | 3,023 | 372 | 113 |
| | 5 | 15,920 | 7,236 | 187 | 57 | 6,130 | 2,786 | 404 | 123 |
| | 6 | 14,780 | 6,718 | 202 | 62 | 5,700 | 2,591 | 435 | 133 |

NOTES

Specifications are subject to change without notification and without incurring obligation.

Pressure and flow shown are the maximum allowable for the particular combination of winch, ratio, motor and drum.

Specifications in this publication are theoretical and may vary depending on hydraulic system, environment, etc.

Line pulls are maximum ratings for the winch only. Wire rope ratings may be lower than the winch rating. Consult the wire rope manufacturer for ratings.

OPTIONS

Consult the factory for high pressure piston motors and available ratios.

MINIMUM FLOW RECOMMENDATION FOR SMOOTH OPERATION
(RECOMMENDED MINIMUM SYSTEM FLOW SHOULD BE 2X THESE VALUES)

| MOTOR | GPM | LPM |
|---------|-----------------|-----|
| 090 | 24 | 91 |
| 110 | 27 | 102 |
| 120 | 28 | 106 |
| 128/064 | CONSULT FACTORY | |

⚠ WARNING ⚠

A minimum of 5 wraps of wire rope must be left on the drum to prevent the load from being supported by the wire rope anchor alone. Since the wire rope anchor is not designed to hold the rated load, failure to leave 5 wraps of wire rope on the drum could cause the load to drop, which could result in property damage, injury or death.