

BRADEN®

PD12C HOIST

MATERIAL LIST SPECIFIC TO PART #05724

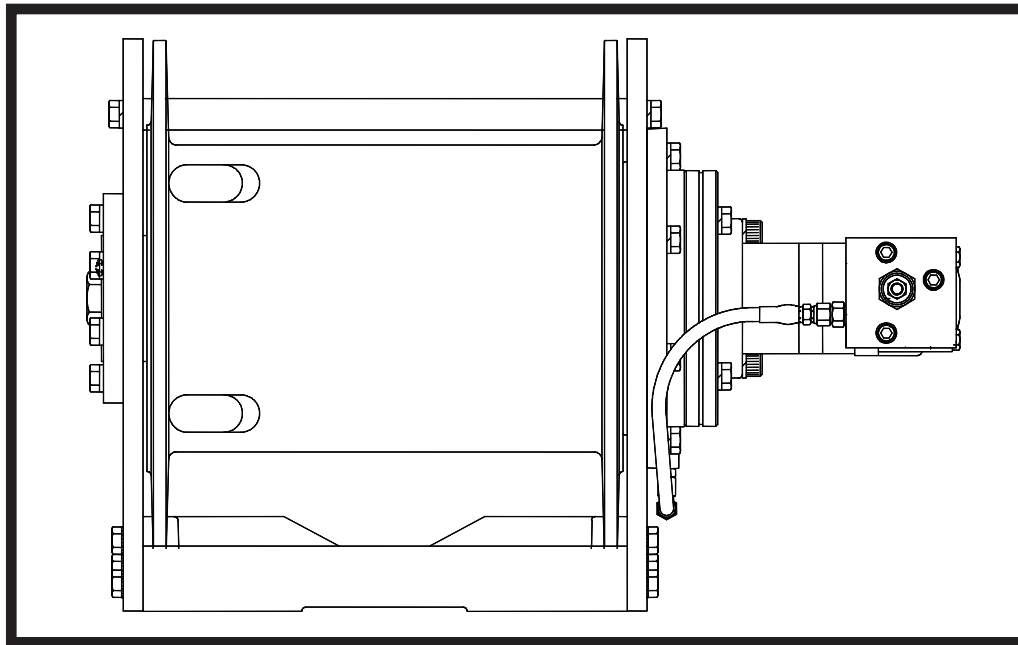

PACCAR WINCH DIVISION

P.O. Box 547 Broken Arrow, Oklahoma 74013

PHONE: (918) 251-8511 FAX: (918) 259-1575

www.paccarwinch.com

This page intentionally left blank

MODEL NUMBER AND SERIAL NUMBER

When information on a hoist is needed always refer to the model number and serial number. Both are located on the motor side end plate as indicated

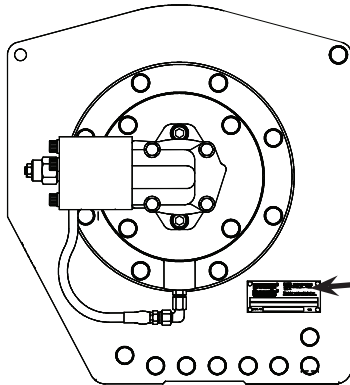

MODEL NUMBER AND SERIAL NUMBER

EXPLANATION OF MODEL NUMBER

PD	12	C	- SPL -	21	080	-	02UL
POWER DRUM	MAX RATING	DESIGN SERIES	SPECIAL	GEAR RATIO	MOTOR SIZE		DRUM SIZE
PD	12	C	SPL	21	080		02UL
DESIGNATES POWER DRUM SERIES HOIST	DESIGNATED 12,000 LB FIRST LAYER LINE PULL	DESIGNATES THE MODEL SERIES RELATING TO DESIGN CHANGES	DESIGNATES SPECIAL DESIGN VARIANT	DESIGNATES TOTAL GEAR REDUCTION (21:1)	DESIGNATES HYDRAULIC MOTOR DISPLACEMENT (8.0 IN. CU/REV)		DESIGNATES THE DRUM SIZE

Oil Capacities - 02UL drum - 6 Pints (2.8 L)

Capacity is approximate. Fill hoist to center of sight gauge in support endplate with drum in a horizontal position

RECOMMENDED PLANETARY GEAR OIL

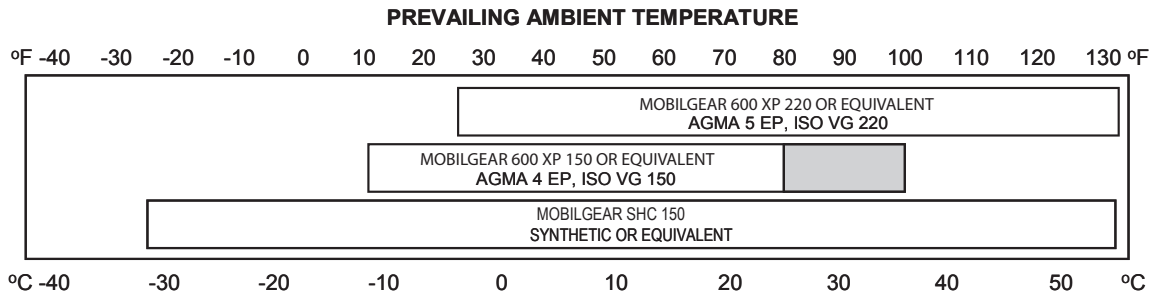

i **NOTE:** SHADED TEMPERATURE RANGE IN THE CHART ABOVE NOT RECOMMENDED FOR SEVERE APPLICATIONS SUCH AS: OFFSHORE CRANES, SUSTAINED FAST DUTY CYCLES OR FREQUENT LIFTING.

Planetary hoists are factory filled with Mobilgear 600 XP 150, or equivalent. Consult your oil supplier for other equivalent oils if required.

Mobil	Shell	Chevron	Texaco
Mobilgear 600 XP 150	Omala 150	Gear Compounds EP 150	Meropa 150
Mobilgear 600 XP 220	Omala 220	Gear Compounds EP 220	Meropa 220

MAIN ASSEMBLY

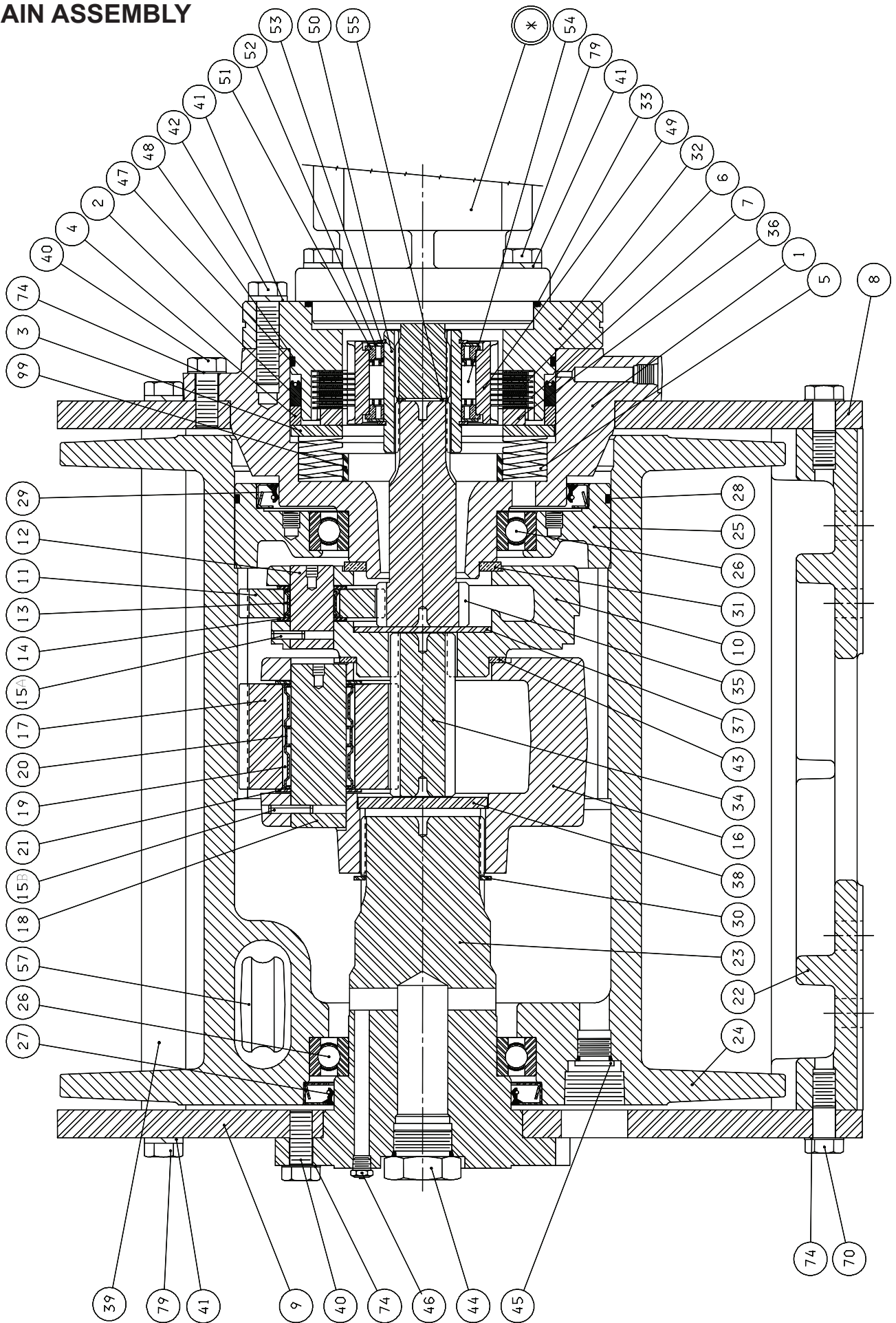

MAIN ASSEMBLY

Item	Description	Part	QTY	Item	Description	Part	QTY
1	BRAKE CYLINDER	100035	1	31	THRUST WASHER	40128	1
2	SEAL	25642	1	32	MOTOR SUPPORT	100097	1
3	PRESSURE PLATE STAMPING	25635	1	33	O-RING	22586	1
4	PISTON BACKUP RING	25636	1	34	SUN GEAR	25608	1
5	DIE SPRING	25644	12	35	PRIMARY SUN GEAR	25714	1
6	DISC-FRICTION	21036	7	36	SPACER	25637	1
7	BRAKE DISK	100027	8	37	PRIMARY SPACER	25729	1
8	SIDEPLATE, MOTOR	106537	1	38	SPACER, OUTPUT	25638	1
9	SIDEPLATE, SUPPORT	106466	1	39	SPACER	26223	1
10	PRIMARY PLANET CARRIER	25715	1	40	CAPSCREW	104174	16
11	PLANET GEAR	26280	3	41	LOCKWASHER	11026	8
12	PRIMARY PLANET GEAR SHAFT	25614	3	42	CAPSCREW	29855	4
13	ROLLER BEARING	24175	3	43	THRUST WASHER	40129	1
14	BEARING RACE	25361	6	44	O-RING PLUG	31386	1
15A	SPIROL PIN	24113	3	45	PLUG-O-RING FLUSH	32411	1
15B	PIN-SPIROL	23584	3	46	RELIEF VALVE	18062	1
16	PLANET CARRIER	25602	1	47	O-RING	24981	1
17	PLANET GEAR	26279	3	48	BACK-UP RING	25643	1
18	PLANET GEAR SHAFT	25613	3	49	OUTER BRAKE RACE	**	1
19	ROLLER BEARING	25292	6	50	INNER BRAKE RACE	**	1
20	BEARING SPACER	25443	3	51	SPRAG BEARING	**	2
21	THRUST WASHER	24306	6	52	THRUST BEARING	24581	2
22	BASE	26344	1	53	SNAP RING	12034	2
23	BEARING SUPPORT	106459	1	54	SPRAG CLUTCH	**	1
24	CABLE DRUM	25518	1	55	RETAINING RING	24506	1
25	CABLE DRUM CLOSURE	26763	1	57	CABLE WEDGE	40130	1
26	BALL BEARING	24110	2	70	CAPSCREW	103314	16
27	OIL SEAL	24109	1	74	LOCKWASHER	12781	32
28	O-RING	21033	1	79	CAPSCREW	104322	4
29	SEAL-OIL	22818	1	99	SPRING SPACER	100200	1

Item	Description	Part	QTY
*	PRIMARY PLANET CARRIER ASSY	81805	1
*	OUTPUT PLANET CARRIER ASSY	81804	1
*	BRAKE CYL ASSY - 2 BOLT A	82268	1
*	SPRAG CLUTCH ASSY	81716	1

** = not sold separately

* = assembly part number

Use Seal Kit #61715

MOTOR GROUP

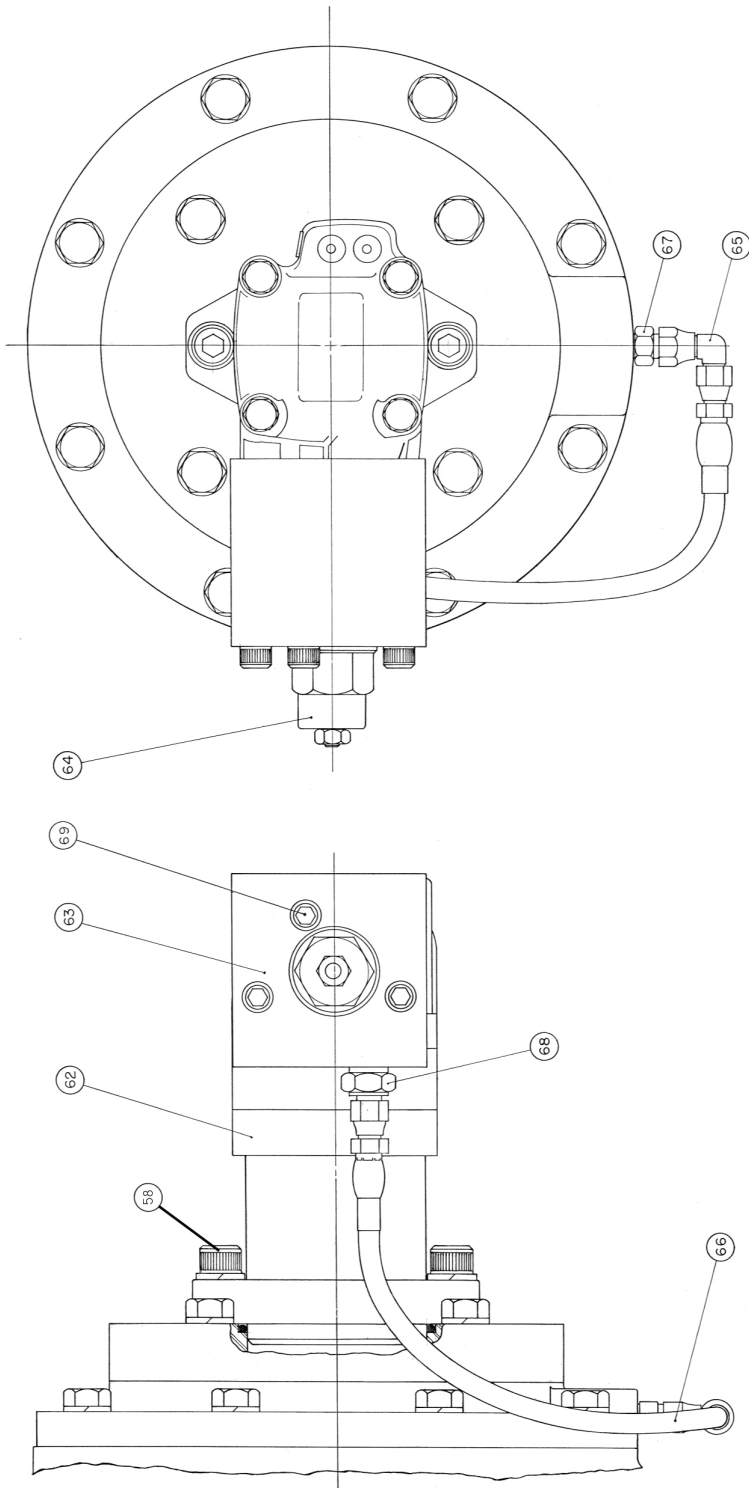

Item	Description	Part	QTY
*	HYD MOTOR SUB-ASSY	61730	1
033	O-RING	22586	1
046	RELIEF VALVE	18062	1
058	CAPSCREW	21908	2
062	HYD MOTOR	26124	1
063	BRAKE VALVE BLOCK	26125	1
064	COUNTERBALANCE CARTRIDGE	26126	1
065	SWIVEL NUT 90 DEG. ELBOW	26140	1
066	HOSE ASSY	25750	1
067	ADAPTER	25864	1
068	ADAPTER	31284	1
069	CAPSCREW	29630	3

This page intentionally left blank

METRIC CONVERSION TABLE

English to Metric

Metric to English

LINEAR

inches (in.)	X 25.4	= millimeters (mm)	millimeters (mm)	X 0.3937	= inches (in.)
feet (ft.)	X 0.3048	= meters (m)	meters (m)	X 3.281	= feet (ft.)
miles (mi.)	X 1.6093	= kilometers (km)	kilometers (km)	X 0.6214	= miles (mi.)

AREA

inches ² (sq.in.)	X 645.15	= millimeters ² (mm ²)	millimeters ² (mm ²)	X 0.000155	= inches ² (sq.in.)
feet ² (sq.ft.)	X 0.0929	= meters ² (m ²)	meters ² (m ²)	X 10.764	= feet ² (sq.ft.)

VOLUME

inches ³ (cu.in.)	X 0.01639	= liters (l)	liters (l)	X 61.024	= inches ³ (cu.in.)
quarts (qts.)	X 0.94635	= liters (l)	liters (l)	X 1.0567	= quarts (qts.)
gallons (gal.)	X 3.7854	= liters (l)	liters (l)	X 0.2642	= gallon (gal.)
inches ³ (cu.in.)	X 16.39	= centimeters ³ (cc)	centimeters ³ (cc)	X 0.06102	= inches ³ (cu.in.)
feet ³ (cu.ft.)	X 28.317	= liters (l)	liters (l)	X 0.03531	= feet ³ (cu.ft.)
feet ³ (cu.ft.)	X 0.02832	= meters ³ (m ³)	meters ³ (m ³)	X 35.315	= feet ³ (cu.ft.)
fluid ounce (fl.oz.)	X 29.57	= millileters (ml)	milliliters (ml)	X 0.03381	= fluid ounce (fl.oz.)

MASS

ounces (oz.)	X 28.35	= grams (g)	grams (g)	X 0.03527	= ounces (oz.)
pounds (lbs.)	X 0.4536	= kilograms (kg)	kilograms (kg)	X 2.2046	= pounds (lbs.)
tons (2000 lbs.)	X 907.18	= kilograms (kg)	kilograms (kg)	X 0.001102	= tons (2000 lbs.)
tons (2000 lbs.)	X 0.90718	= metric tons (t)	metric tons (t)	X 1.1023	= tons (2000 lbs.)
tons (long) (2240 lbs.)	X 1013.05	= kilograms (kg)	kilograms (kg)	X 0.000984	= tons (long) (2240 lbs.)

PRESSURE

inches Hg (60 °F)	X 3600	= kilopascals (kPa)	kilopascals (kPa)	X 0.2961	= inches Hg (60 °F)
pounds/sq.in. (PSI)	X 6.895	= kilopascals (kPa)	kilopascals (kPa)	X 0.145	= pounds/sq.in. (PSI)
pounds/sq.in. (PSI)	X 0.0703	= kilograms/sq.cm. (kg/cm ²)	kilograms/sq.cm. (kg/cm ²)	X 14.22	= pounds/sq.in. (PSI)
pounds/sq.in. (PSI)	X 0.069	= bars	bars	X 14.5	= pounds/sq.in. (PSI)
inches H ₂ O (60 °F)	X 0.2488	= kilopascals (kPa)	kilopascals (kPa)	X 4.0193	= inches H ₂ O (60 °F)
bars	X 100	= kilopascals (kPa)	kilopascals (kPa)	X 0.01	= bars

POWER

horsepower (hp)	X 0.746	= kilowatts (kW)	kilowatts (kW)	X 1.34	= horsepower (hp)
ft.-lbs./min.	X 0.0226	= watts (W)	watts (W)	X 44.25	= ft.-lbs./min.

TORQUE

pound-inches (in.-lbs.)	X 0.11298	= newton-meters (N-m)	newton-meters (N-m)	X 8.851	= pound-inches (in.-lbs.)
pound-feet (ft.-lbs.)	X 1.3558	= newton-meters (N-m)	newton-meters (N-m)	X 0.7376	= pound-feet (ft.-lbs.)
pound-feet (ft.-lbs.)	X .1383	= kilograms/meter (kg-m)	kilogram/meter (kg-m)	X 7.233	= pound-feet (ft.-lbs.)

VELOCITY

miles/hour (m/h)	X 0.11298	= kilometers/hour (km/hr)	kilometers/hour (km/hr)	X 0.6214	= miles/hour (m/h)
feet/second (ft./sec.)	X 0.3048	= meter/second (m/s)	meters/second (m/s)	X 3.281	= feet/second (ft./sec.)
feet/minute (ft./min.)	X 0.3048	= meter/minute (m/min)	meters/minute (m/min)	X 3.281	= feet/minute (ft./min.)

TEMPERATURE

$$^{\circ}\text{Celsius} = 0.556 (^{\circ}\text{F} - 32)$$

$$^{\circ}\text{Fahrenheit} = (1.8 \times ^{\circ}\text{C}) + 32$$

COMMON METRIC PREFIXES

mega	(M)	= 1,000,000 or 10 ⁶	deci	(d)	= 0.1 or 10 ⁻¹
kilo	(k)	= 1,000 or 10 ³	centi	(c)	= 0.01 or 10 ⁻²
hecto	(h)	= 100 or 10 ²	milli	(m)	= 0.001 or 10 ⁻³
deka	(da)	= 10 or 10 ¹	micro	(μ)	= 0.000.001 or 10 ⁻⁶