

# UBL Utility Bumper System

12,000-15,000 lb (5,443-6,804 kg) Rated Line Pull

# BRADEN<sup>®</sup>

A PACCAR COMPANY

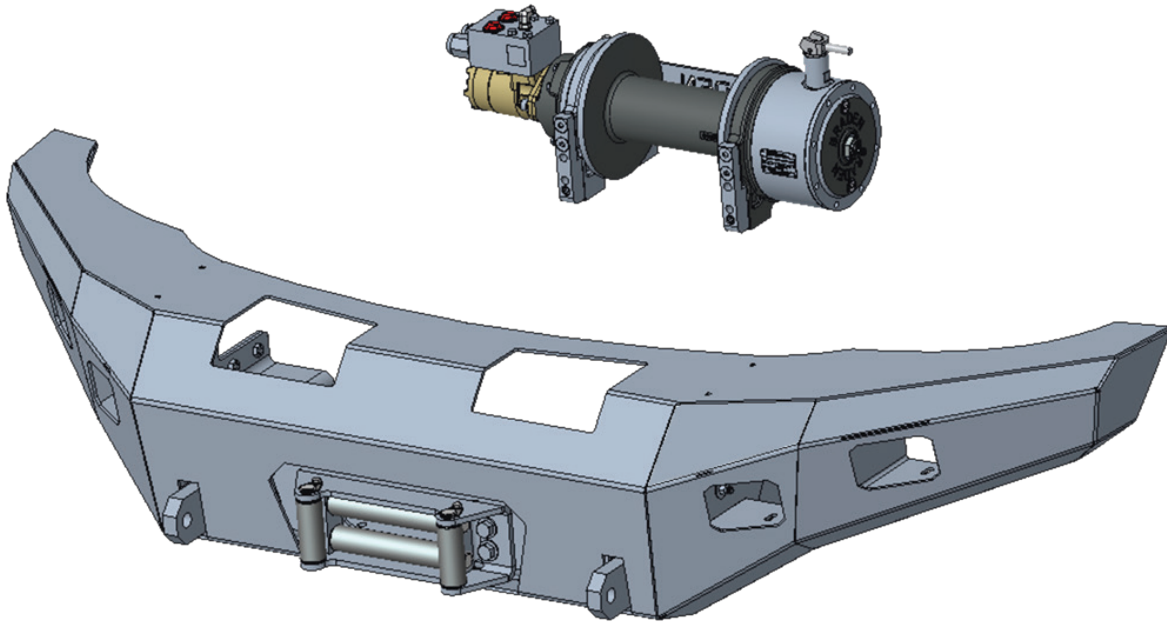

- Lightweight aluminum shell
- Heavy duty steel super-structure with integrated tow-eyes
- Direct bolt-on installation for Ford F350/F450/F550/F600 and Dodge 4400/5500 trucks (model years 2017-current)
- Modular design allows fast and easy installation without the need for custom brackets or welding
- Contoured profile offers increased ground clearance and improved turning radius
- SAE J706 compliant

#### Winch

TR12 - 09921 (Roller) or 04164 (Hawse) for Ford  
TR12 - 010016 (Roller) or 010018 (Hawse) for Dodge  
TR15 - 09922 (Roller) or 04165 (Hawse) for Ford  
TR15 - 010017 (Roller) or 010019 (Hawse) for Dodge

#### System Weight\*

275 lb (125 kg)

#### Vehicle Compatibility

Light Duty

#### Rope Diameters (Wire or Synthetic)

7/16" (11 mm), 1/2" (13 mm)

#### Extension Shaft

N/A

#### Toolbox

N/A

#### Accessories Included

Dual Light Package (Work and Flood)  
Roller or Hawse Fairlead

*\*Does not include rope.*



## Applications

- Towing & Recovery
- Utility

# UBL Utility Bumper System

12,000-15,000 lb (5,443-6,804 kg) Rated Line Pull

# BRADEN<sup>®</sup>

A PACCAR COMPANY

## Line Pull & Rope Capacity

		Layer 1	Layer 2	Layer 3	Layer 4	Layer 5
<b>Line Pull</b>	TR12	12,000 lb (5,442 kg)	10,020 lb (4,525 kg)	8,600 lb (3,900 kg)	7,530 lb (3,415 kg)	6,700 lb (3,039 kg)
	TR15	15,000 lb (6,804 kg)	12,520 lb (5,678 kg)	10,750 lb (4,876 kg)	9,420 lb (4,272 kg)	8,380 lb (3,801 kg)
<b>Rope Capacity</b>	7/16" (11 mm)	23 ft (7.1 m)	51 ft (15.7 m)	84 ft (25.6 m)	121 ft (37 m)	163 ft (49.7 m)
	1/2" (13 mm)	21 ft (6.3 m)	46 ft (14.1 m)	76 ft (23.2 m)	111 ft (33.7 m)	

Based on pressure of 2,450 psi (169 bar), 20 gpm (76 lpm) and 9.6 CID motor (TR15) or 8.0 CID motor (TR12) with 7/16" (11 mm) rope.  
Actual performance will vary dependent on hydraulic system, motor, drum and cable sizes. Rope capacity based on 90% of theoretical.

## Line Speed Based on Hydraulic Flow

		Layer 1	Layer 2	Layer 3	Layer 4	Layer 5
<b>20 gpm</b>	TR12	46 fpm (14 mpm)	56 fpm (17.1 mpm)	65 fpm (19.8 mpm)	74 fpm (22.6 mpm)	83 fpm (25.3 mpm)
	TR15	39 fpm (12 mpm)	46 fpm (14 mpm)	54 fpm (16.5 mpm)	62 fpm (18.9 mpm)	69 fpm (21 mpm)
<b>8 gpm</b>	TR12	17.6 fpm (5.4 mpm)	21.1 fpm (6.4 mpm)	24.5 fpm (7.5 mpm)	28 fpm (8.5 mpm)	31.5 fpm (9.6 mpm)
	TR15	14.1 fpm (4.3 mpm)	16.9 fpm (5.2 mpm)	19.7 fpm (6 mpm)	22.5 fpm (6.9 mpm)	25.3 fpm (7.7 mpm)
<b>5 gpm</b>	TR12	10.4 fpm (3.2 mpm)	12.4 fpm (3.8 mpm)	14.4 fpm (4.4 mpm)	16.5 fpm (5 mpm)	18.5 fpm (5.6 mpm)
	TR15	8.4 fpm (2.6 mpm)	10.1 fpm (3.1 mpm)	11.7 fpm (3.6 mpm)	13.4 fpm (4.1 mpm)	15 fpm (4.6 mpm)

Based on pressure of 2,450 psi (169 bar), hydraulic flow shown and 9.6 CID motor (TR15) or 8.0 CID motor (TR12) with 7/16" (11 mm) rope.

## Dimensions (09921/09922 shown.)

