

# MATERIAL LIST

# AMS7 AHS7

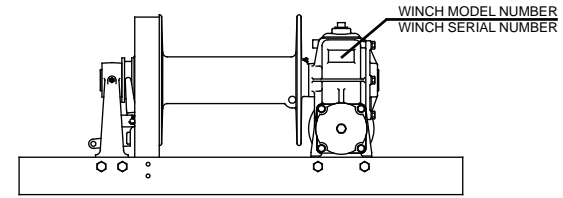
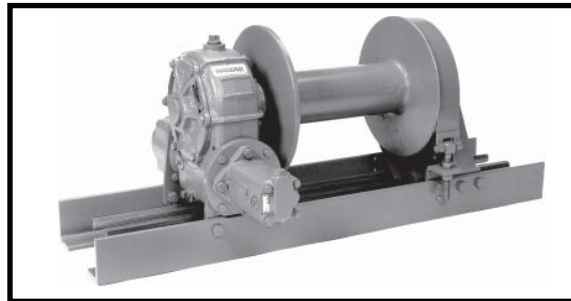

Serial Numbers and Model Numbers are stamped into the top of the worm gear housing.

Always refer to the Serial Number and Model Number when requesting information or service parts

#### TO ORDER:

- 1) List model and serial numbers of the winch.
- 2) Refer to illustrations and select the component(s) needed and note item number.
- 3) Find item number on material list, show part number, description and quantity on your order.
- 4) Refer to parts price list and show price for each component or assembly.

#### SPECIFICATIONS

##### Recommended Worm Gear Oil:

We have published the following specifications to help you determine which lubricant is best suited to your application. For simplicity, Braden has listed one readily available product in each temperature range which has been tested and found to meet our specifications. This is not to say that other lubricant brands would not perform equally as well. If the following lubricant brands are not available in your area, make certain your lubricant vendor supplies you with oil that is equivalent to those products listed below.

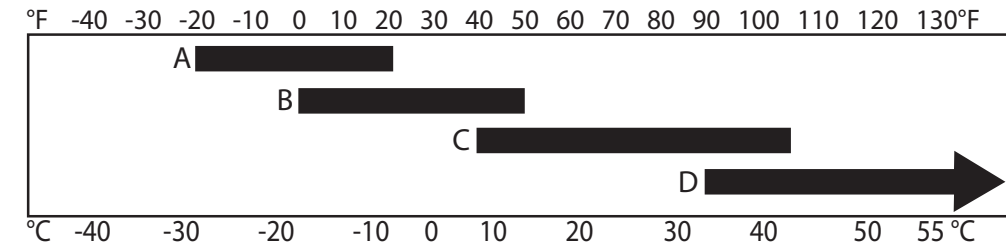

- A. AGMA Grade 3 EP; Mobilgear 600xp 100 or equivalent
- B. AGMA Grade 5 EP; Mobilgear 600xp 220 or equivalent
- C. AGMA Grade 7 EP; Mobilgear 600xp 460 or equivalent
- D. AGMA Grade 8 EP; Mobilgear 600xp 680 or equivalent

##### Brand recommendations in tier C climate range:

MOBIL Mobilgear 600xp 460  
SHELL Omala 460  
CHEVRON Gear Compounds EP460  
TEXACO Meropa 460

### ⚠ WARNING ⚠

**DO NOT** use aftermarket additives in worm gear oil. Some additives may contain substances which could cause glazing of the brake discs or impede the firm locking action in the brake rotor assembly. Both Symptoms could reduce load control which may result in property damage, severe personal injury or death

# BRADEN AMS7, AHS7 - Components

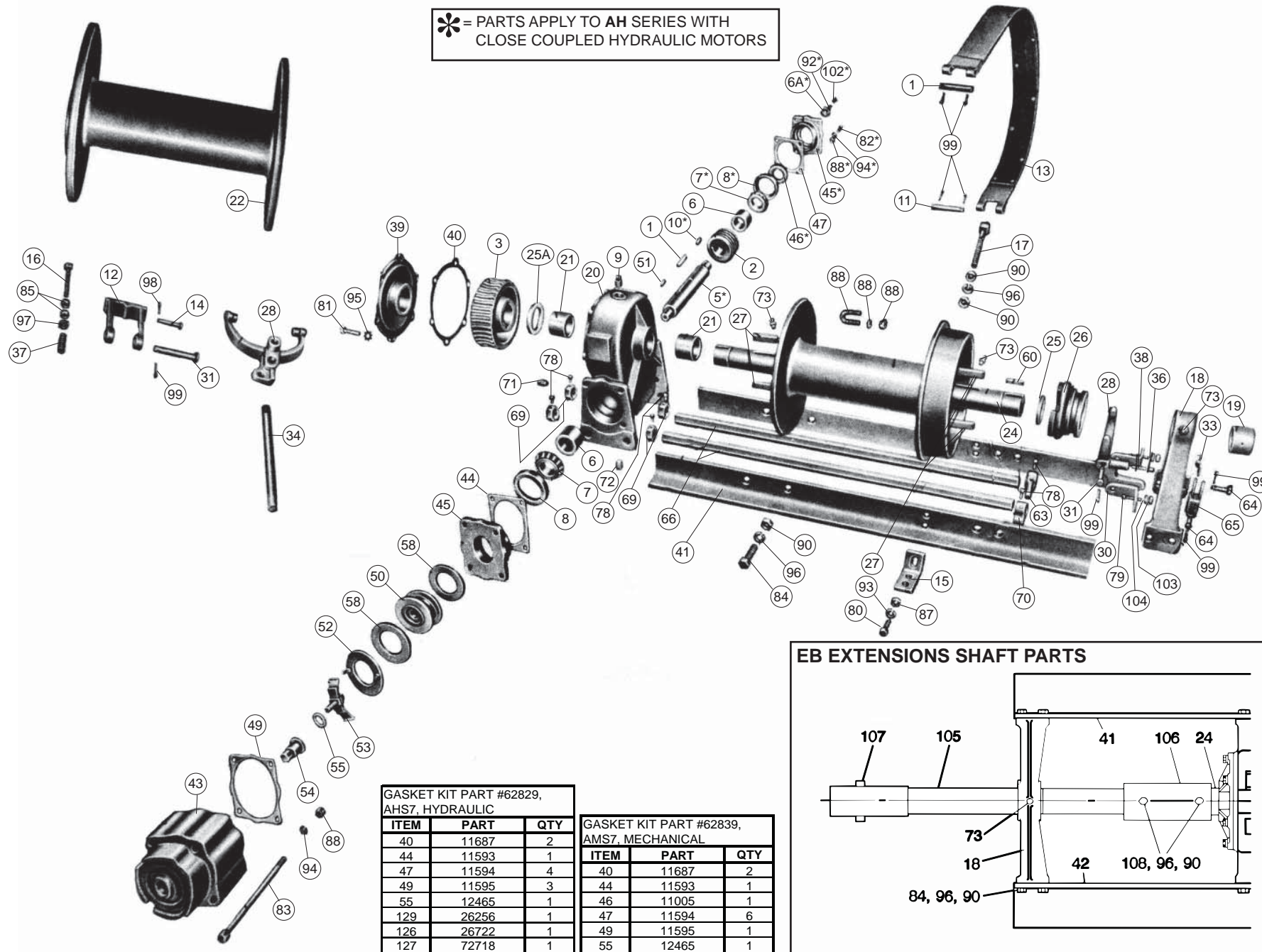

| GASKET KIT PART #62829, AHS7, HYDRAULIC |       |     |
|---|-------|-----|
| ITEM                                    | PART  | QTY |
| 40                                      | 11687 | 2   |
| 44                                      | 11593 | 1   |
| 47                                      | 11594 | 4   |
| 49                                      | 11595 | 3   |
| 55                                      | 12465 | 1   |
| 129                                     | 26256 | 1   |
| 126                                     | 26722 | 1   |
| 127                                     | 72718 | 1   |

| GASKET KIT PART #62839, AMS7, MECHANICAL |       |     |
|--|-------|-----|
| ITEM                                     | PART  | QTY |
| 40                                       | 11687 | 2   |
| 44                                       | 11593 | 1   |
| 46                                       | 11005 | 1   |
| 47                                       | 11594 | 6   |
| 49                                       | 11595 | 1   |
| 55                                       | 12465 | 1   |

### EB EXTENSIONS SHAFT PARTS

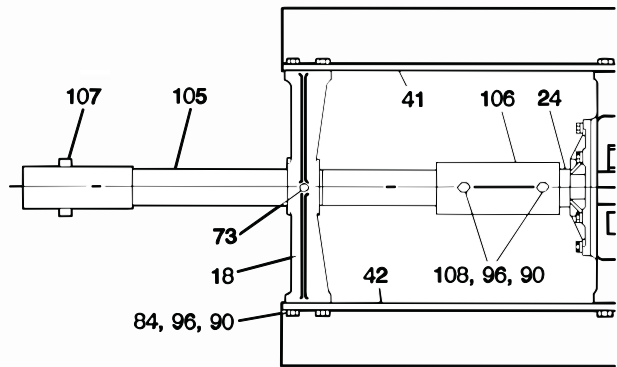

| MATERIAL LIST VARIABLES                                      |                                |                  |                   |                   |                  |                     |                     |      |
|--|--------------------------------|------------------|-------------------|-------------------|------------------|---------------------|---------------------|------|
| AMS7-15, AMS7-15A, AMS7-15B, AMS7-12, AMS7-15AEB, AMS7-15BEB |                                |                  |                   |                   |                  |                     |                     |      |
| ITEM NO.   | DESCRIPTION                    | AMS7-15 PART NO. | AMS7-15A PART NO. | AMS7-15B PART NO. | AMS7-12 PART NO. | AMS7-15AEB PART NO. | AMS7-15BEB PART NO. | QTY. |
| 11   | Brake Band Pin                 | ---              | ---               | 11051             | ---              | ---                 | 11051               | 2    |
| 12   | Brake Shoe Assembly            | 88010            | 88010             | ---               | 88010            | 88010               | ---                 | 1    |
| 13   | Brake Band Assembly            | ---              | ---               | 81588             | ---              | ---                 | 81588               | 1    |
| 14   | Link Pin                       | 18017            | 18017             | ---               | 18017            | 18017               | ---                 | 1    |
| 15   | Bracket                        | ---              | ---               | 11299             | ---              | ---                 | 11299               | 1    |
| 16   | Link                           | 11587            | 11587             | ---               | 11587            | 11587               | ---                 | 1    |
| 17   | Link                           | ---              | ---               | 11630             | ---              | ---                 | 11630               | 1    |
| 18   | Bearing Leg Assembly*          | 81126            | 81126             | 81126             | 81126            | ---                 | ---                 | 1    |
| 18   | Bearing Leg Assembly*          | ---              | ---               | ---               | ---              | 81126               | 81126               | 2    |
| 19   | Bushing                        | 11589            | 11589             | 11589             | 11589            | ---                 | ---                 | 1    |
| 19   | Bushing                        | ---              | ---               | ---               | ---              | 11589               | 11589               | 2    |
| 22   | Cable Drum                     | 11680            | 11680             | 11615             | 11679            | 11680               | 11615               | 1    |
| 24   | Cable Drum Shaft               | 23932            | 23932             | 23932             | 24249            | 11283               | 11283               | 1    |
| 28   | Shifter Fork                   | 11686            | 11474             | 11474             | 11686            | 11474               | 11474               | 1    |
| 31   | Pivot Pin                      | 18021            | 18021             | 11400             | 18021            | 18021               | 11400               | 1    |
| 34   | Shifter Handle                 | 11591            | ---               | ---               | 11591            | ---                 | ---                 | 1    |
| 37   | Brake Spring                   | 18002            | 18002             | ---               | 18002            | 18002               | ---                 | 1    |
| 41   | Rear Base Angle                | 11282            | 11282             | 11282             | 24251            | 23050               | 23050               | 1    |
| 42   | Front Base Angle               | 11281            | 11281             | 11281             | 24250            | 23049               | 23049               | 1    |
| 63   | Clutch Lever                   | ---              | 11981             | 11981             | ---              | 11981               | 11981               | 1    |
| 64   | Clevis Pin                     | ---              | 11480             | 11480             | ---              | 11480               | 11480               | 2    |
| 65   | Clevis Pin                     | ---              | 11616             | 11616             | ---              | 11616               | 11616               | 1    |
| 66   | Control Shaft                  | ---              | 11482             | ---               | ---              | 11482               | ---                 | 1    |
| 66   | Control Shaft                  | ---              | ---               | 11482             | ---              | ---                 | 11482               | 2    |
| 69   | Collar                         | ---              | 11669             | ---               | ---              | 11669               | ---                 | 2    |
| 69   | Collar                         | ---              | ---               | 11669             | ---              | ---                 | 11669               | 4    |
| 70   | Lever                          | ---              | ---               | 11066             | ---              | ---                 | 11066               | 1    |
| 73   | Grease Fitting                 | 18047            | 18047             | 18047             | 18047            | ---                 | ---                 | 3    |
| 73   | Grease Fitting                 | ---              | ---               | ---               | ---              | 18047               | 18047               | 4    |
| 78   | Setscrew                       | ---              | 13957             | ---               | ---              | 13957               | ---                 | 3    |
| 78   | Setscrew                       | ---              | ---               | 13957             | ---              | ---                 | 13957               | 6    |
| 80   | Capscrew (3/8 - 16 X 1 1/2 G5) | ---              | ---               | 22694             | ---              | ---                 | 22694               | 2    |
| 84   | Capscrew (5/8 - 18 x 2 G8)     | 22699            | 22699             | 22699             | 22699            | ---                 | ---                 | 8    |
| 84   | Capscrew (5/8 - 18 x 2 G8)     | ---              | ---               | ---               | ---              | 22699               | 22699               | 12   |
| 85   | Jam Nut (1/8 - 28)             | 13468            | 13468             | ---               | 13468            | 13468               | ---                 | 2    |
| 87   | Nut (3/8 - 16 NC)              | ---              | ---               | 11780             | ---              | ---                 | 11780               | 2    |
| 90   | Nut (5/8 - 18 NF)              | 22702            | 22702             | ---               | 22702            | ---                 | ---                 | 8    |
| 90   | Nut (5/8 - 18 NF)              | ---              | ---               | 22702             | ---              | ---                 | ---                 | 10   |
| 90   | Nut (5/8 - 18 NF)              | ---              | ---               | ---               | ---              | 22702               | ---                 | 14   |
| 90   | Nut (5/8 - 18 NF)              | ---              | ---               | ---               | ---              | ---                 | 22702               | 16   |
| 92   | Lockwasher (5/16)              | 11024            | 11024             | ---               | 11024            | 11024               | ---                 | 1    |
| 93   | Lockwasher (3/8)               | ---              | ---               | 18003             | ---              | ---                 | 18003               | 2    |
| 96   | Lockwasher (5/8)               | 11028            | 11028             | ---               | 11028            | ---                 | ---                 | 8    |
| 96   | Lockwasher (5/8)               | ---              | ---               | 11028             | ---              | ---                 | ---                 | 9    |
| 96   | Lockwasher (5/8)               | ---              | ---               | ---               | ---              | 11028               | ---                 | 14   |
| 96   | Lockwasher (5/8)               | ---              | ---               | ---               | ---              | ---                 | 11028               | 15   |
| 97   | Washer (1/4)                   | 11072            | 11072             | ---               | 11072            | 11072               | ---                 | 1    |
| 98   | Cotter Pin                     | 11078            | 11078             | ---               | 11078            | 11078               | ---                 | 1    |
| 99   | Cotter Pin                     | 18008            | ---               | ---               | 18008            | ---                 | ---                 | 1    |
| 99   | Cotter Pin                     | ---              | 18008             | ---               | ---              | 18008               | ---                 | 3    |
| 99   | Cotter Pin                     | ---              | ---               | 18008             | ---              | ---                 | 18008               | 7    |
| 105  | Extension Shaft                | ---              | ---               | ---               | ---              | 13372               | 13372               | 1    |
| 106  | Coupling                       | ---              | ---               | ---               | ---              | 22899               | 22899               | 1    |
| 107  | Capstan Pin                    | ---              | ---               | ---               | ---              | 11980               | 11980               | 1    |
| 108  | Capscrew                       | ---              | ---               | ---               | ---              | 21685               | 21685               | 2    |

\*BEARING LEG ASSEMBLIES INCLUDE BUSHING

| BASIC MATERIAL LIST         |       |                       |      |  |
|-----------------------------|-------|-----------------------|------|--|
| AMS7-15, AMS7-15A, AMS7-15B |       |                       |      |  |
| ITEM                        | PART  | DESCRIPTION           | QTY. |  |
| 1                           | 11606 | Key                   | 1    |  |
| 2                           | 11190 | Worm, Right Hand      | 1    |  |
|                             | 11189 | Worm, Left Hand       | 1    |  |
| 3                           | 22895 | Worm Gear, Right Hand | 1    |  |
|                             | 22894 | Worm Gear, Left Hand  | 1    |  |
| 5                           | 11688 | Worm Shaft            | 1    |  |
| 6                           | 11689 | Spacer                | 2    |  |
| 6A                          | 18045 | Washer                | 1    |  |
| 7                           | 18006 | Bearing Cone          | 2    |  |
| 8                           | 18043 | Bearing Cup           | 2    |  |
| 9                           | 22775 | Plug                  | 1    |  |
| 10                          | 23367 | Key                   | 1    |  |
| 20                          | 81864 | Worm Housing Assembly | 1    |  |
| 21                          | 12968 | Bushing               | 2    |  |
| 25                          | 11002 | Retaining Ring        | 1    |  |
| 25A                         | 11280 | Thrust Ring           | 1    |  |
| 26                          | 11685 | Clutch                | 1    |  |

| ITEM | PART  | DESCRIPTION           | QTY. | ITEM | PART  | DESCRIPTION                      | QTY. |
|------|-------|-----------------------|------|------|-------|----------------------------------|------|
| 27   | 11004 | Key                   | 4    | 55   | 12465 | O-Ring                           | 1    |
| 30   | 11607 | Bracket               | 2    | 58   | 11979 | Friction Disc                    | 2    |
| 33   | 11612 | Shifter Lock          | 1    | 71   | 18009 | Level Plug                       | 1    |
| 36   | 11608 | Poppet                | 1    | 72   | 18010 | Drain Plug                       | 1    |
| 38   | 11592 | Spring                | 1    | 76   | 11776 | Capscrew (3/8 - 16 X 1 1/4 G5)   | 2    |
| 39   | 81045 | Worm Housing Cover    | 1    | 79   | 22694 | Capscrew (3/8 - 16 X 1 1/2 G5)   | 2    |
| 40   | 11687 | Gasket                | 2    | 81   | 21964 | Capscrew (7/16 - 14 X 1 G5)      | 6    |
| 43   | 11613 | Worm Brake Housing    | 1    | 82   | 23585 | Capscrew (7/16 - 20 X 2 G8)      | 4    |
| 44   | 11593 | Gasket                | 1    | 83   | 23586 | Capscrew (7/16 - 20 X 4 1/2 G8)  | 4    |
| 45   | 22756 | Bearing Container     | 2    | 88   | 12794 | Nut (7/16 - 20 NF)               | 8    |
| 46   | 11005 | Grease Seal           | 1    | 94   | 11025 | Lockwasher (7/16)                | 10   |
| 47   | 11594 | Gasket                | 6    | 95   | 11014 | Lockwasher (7/16 external tooth) | 6    |
| 49   | 11595 | Gasket                | 1    | 100  | 11590 | Cable Clamp                      | 1    |
| 50   | 81114 | Rotor Assembly        | 1    | 101  | 13566 | Nut (7/16 - 14 NC)               | 2    |
| 51   | 18044 | Key                   | 1    | 102  | 11047 | Capscrew (5/16 - 24 X 3/4 G5)    | 1    |
| 52   | 11610 | Pressure Plate        | 1    | 103  | 11780 | Nut (3/8 - 16 NC)                | 4    |
| 53   | 88006 | Brake Spring Assembly | 1    | 104  | 18003 | Lockwasher (3/8)                 | 4    |
| 54   | 11599 | Adjusting Nut         | 1    |      |       |                                  |      |

Note: Refer to "Material List Variables" for items not shown in basic material list.

NOTE: Each bracket (item 30) takes 2 capscrews (1 each, items 76 & 79), 2 nuts (item 103) and 2 lockwashers (item 104). Item 76 with nuts and lockwashers are not shown in the drawing

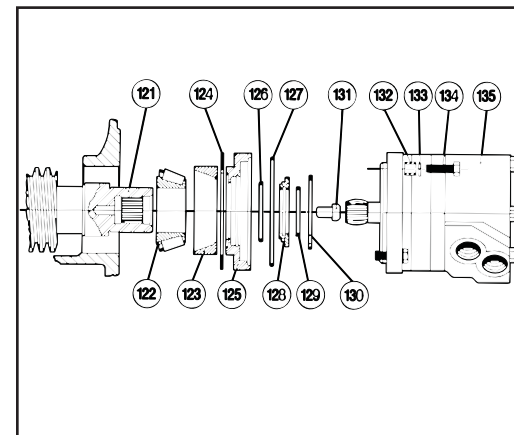

| AH SERIES PARTS |        |  |      |  |
|-----------------|--------|--|------|--|
| ITEM            | PART   | DESCRIPTION                              | QTY. |  |
| 121             | 26719  | Worm Shaft                               | 1    |  |
| 122             | 26258  | Bearing Cone                             | 1    |  |
| 123             | 26257  | Bearing Cup                              | 1    |  |
| 124             | 11595  | Gasket                                   | 1    |  |
| 125             | 26012  | Bearing Container                        | 1    |  |
| 126             | 26722  | O-Ring                                   | 1    |  |
| 127             | 72718  | O-Ring                                   | 1    |  |
| 128             | 26255  | Seal Container                           | 1    |  |
| 129             | 26256  | Quad Ring                                | 1    |  |
| 130             | 25700  | Retaining Ring                           | 1    |  |
| 131             | 26263  | Rest Button                              | 1    |  |
| 132             | ---    | NOT USED                                 | ---  |  |
| 133             | 11026  | Lockwasher (1/2)                         | 4    |  |
| 134             | 104174 | Capscrew (1/2 - 13 X 1 1/4 G8 Z)         | 4    |  |
| 135             | 26310  | Hyd Motor, Single Speed (Char-Lynn)      | 1    |  |
|                 | 101166 | Hyd Motor, 2-Speed (Parker, elec. shift) | 1    |  |